

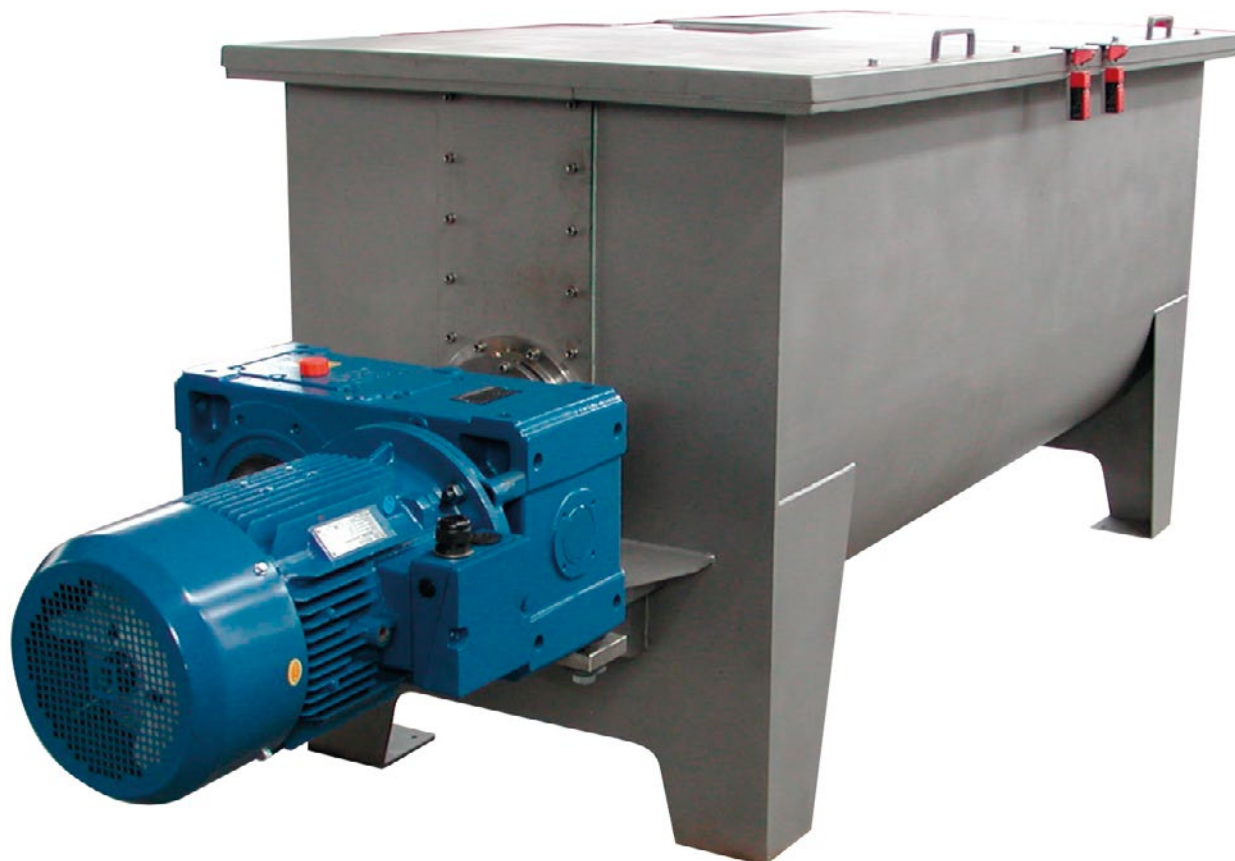

PLANTS FOR THE PROCESSING OF BY-PRODUCTS OF SLAUGHTER

» Mixer type ACT MIX2 - MIX4



Characteristics

The mixer is usually used to mix products with different organic values but similar structure, with the purpose to obtain a final homogeneous product for animal or human

feeding. For the human feeding all the component parts of the mixer that are in contact with the product have to be realized in a specific stainless steel. This machinery is

particularly indicated for the mixture production based on meat, in the field of the Pet-food.

Receiving hoppers
Conveyor belt with metal detector
Shredder
Bone crusher
Mincer
Elliptical rotor pump
Screw conveyor
Pneumatics conveyor
Continuous/Discontinuous hydrolizer

Discontinuous cooker sterilizer
Continuous cooker
Continuous pre-heater
Continuous dryer
Air and water condenser
Continuous single screw press
Continuous double screw press
Feather and bristle press
Line for blood coagulation

Continuous cooler for meal
Mixer
Hammer mill
Vibrating separator
Solids and liquids storing silos
Electrical panel
Scrubber system
Steam generator
Evaporators



PLANTS FOR THE PROCESSING OF BY-PRODUCTS OF SLAUGHTER

Technical data

A few technical capacity data and dimensional

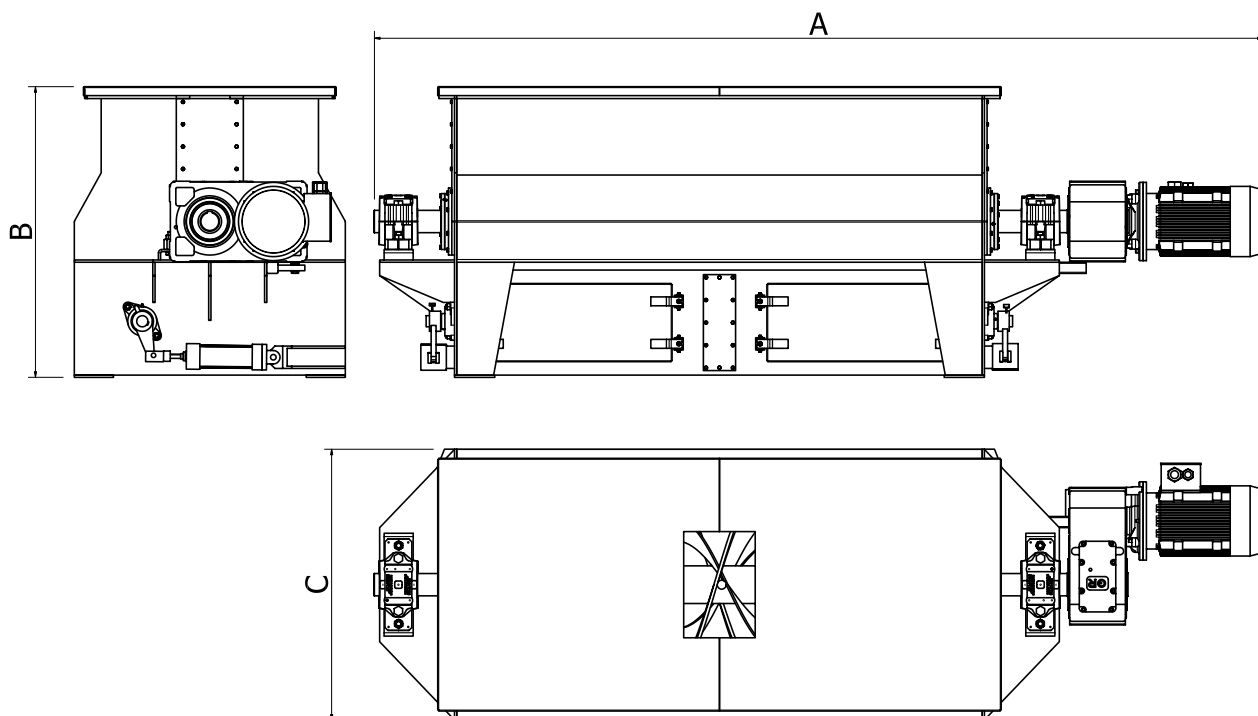

ACT	MIX2	MIX4
Weight (Kg)	1700	3400
Power (KW)	15	30
A mm	4000	5000
Bmm	1300	1800
Cmm	1200	1500



The dimensions and datas are purely indicative. The constructor reserves itself the right to modify them, in case technical-functional needs require it.

Agricarnitec Santini E C. Srl

Via Carlo Goldoni, 7 - 20063 Cernusco sul Naviglio (MI) - Italy

Tel: +39 02 9249089 - Fax: +39 02 9245275 - E-mail: act@agricarnitec.it

www.agricarnitec.com

